

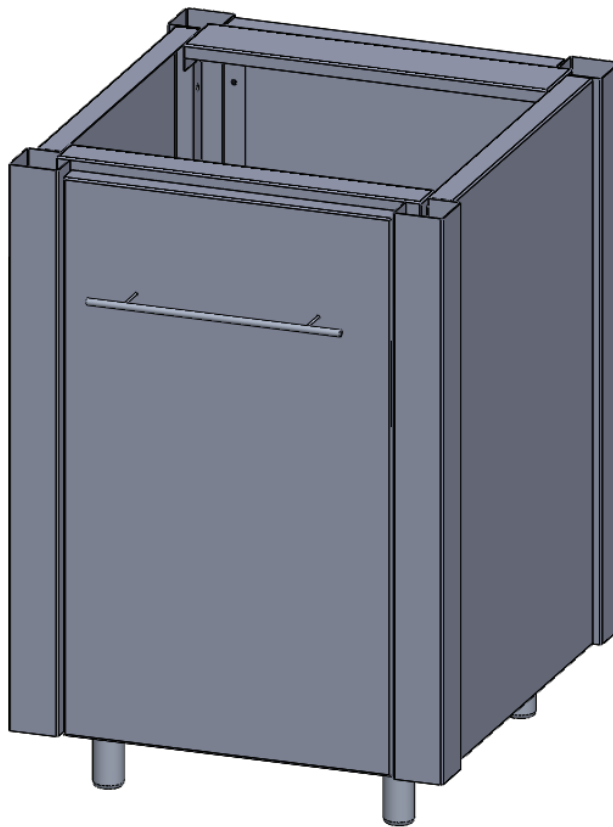

Sierra[®]

OUTDOOR DESIGNS

24 INCH TRASH CABINET



For questions, problems or missing parts, please contact
Cardinal Systems, Inc. Customer Service
8:00 a.m. - 5:00 p.m., EST Monday-Friday

570-385-4733

customerservice@cardinalsystemsinc.com

ASSEMBLY INSTRUCTIONS

Table of Contents

Safety Information	3
Warranty	4
Pre-Assembly	5
Planning the Assembly	
Hardware Included	
Parts	
Assembly	8
Appendix A	14

Skill Level

Intermediate

NOTE: It is recommended that 2 people assemble the cabinet.

Safety Information



WARNING: Do NOT store any type of chemicals in cabinet.



DANGER: Please keep children out of the assembly area.



WARNING: Heavy objects. Lift with care and/or with a second person.



WARNING: Some panels have sharp edges. Please wear appropriate gloves when handling.

Warranty Information

Cardinal Systems, Inc. warrants to the original consumer purchaser that its Sierra Outdoor Designs cabinets are free from manufacturing defects and workmanship for the useful lifetime of the product.

This warranty is not transferable and is for residential applications only. This warranty applies only to cabinets purchased through an authorized Cardinal Systems, Inc. dealer. This warranty is in lieu of all other implied or expressed warranties.

Cardinal Systems, Inc. uses high quality material in our products, however, they are not impervious to rust and are not covered by this warranty, but can be minimized or eliminated with proper care and cleaning. Surface corrosion and discoloration are a natural reaction of stainless steel to environmental factors. Grills, refrigerators, other appliances and faux stone panels carry individual warranty programs through the original equipment manufacturer.

Cardinal Systems, Inc. reserves the right to make changes in design, construction materials and prices as required and as improvements are developed, without obligation to incorporate such changes in cabinetry or related products previously manufactured by Cardinal Systems, Inc. In no event shall Cardinal Systems, Inc. be liable for incidental or consequential damage.

All claims for defective cabinets or components must be submitted to Cardinal Systems, Inc. in writing to warranty@cardinalsystemsinc.com. Defects alleged to be present must be specified. At the discretion of Cardinal Systems, Inc., we will either repair or replace any defective cabinets or components. An authorized representative of Cardinal Systems, Inc. must review complaints about defective surface finishes. This warranty does not cover scratches or dents to stainless steel surfaces during installation or normal use as it is not defective material or workmanship.

Cardinal Systems, Inc. will not be responsible for any expense involved in removing or reinstalling cabinetry with a defective finish. Cardinal Systems, Inc. reserves the option of either approving field repair or returning the cabinetry or component to the factory for correction. If a field repair is possible, an accurate estimate of the cost must be obtained. No action can be taken without authorization from Cardinal Systems, Inc.

Some states do not allow the exclusion or limitation of incidental or consequential damages, so the above limitations and exclusion may not apply to some purchasers. This warranty gives you specific legal rights. You may have other rights, which vary from state to state.

Pre-Assembly

Planning Assembly

It is recommended that 2 people assemble cabinet.

It is recommended to peel off protective coating in the area where the pieces meet, and leave protective coating on the rest of the areas until you are finished.

Hardware Included

Part #	Description	Quantity
L1-0002	1/4-20 x 1/2 Button Soc Cap Screw	46
L1-0014	5/32 Short Arm Hex key	1
L1-0010	1/4" Internal Tooth Lockwasher	4
L2-0001	Equip Leg 4" Protruding Stud Hex Toe	4
L2-0003	Door Handle, Bar Pull	1
L1-0004	8-32 x 1 3/4" Button Soc Cap Screw	2
L1-0013	3/32 Short Arm Hex Key	1

NOTE: Hardware not shown to actual size.

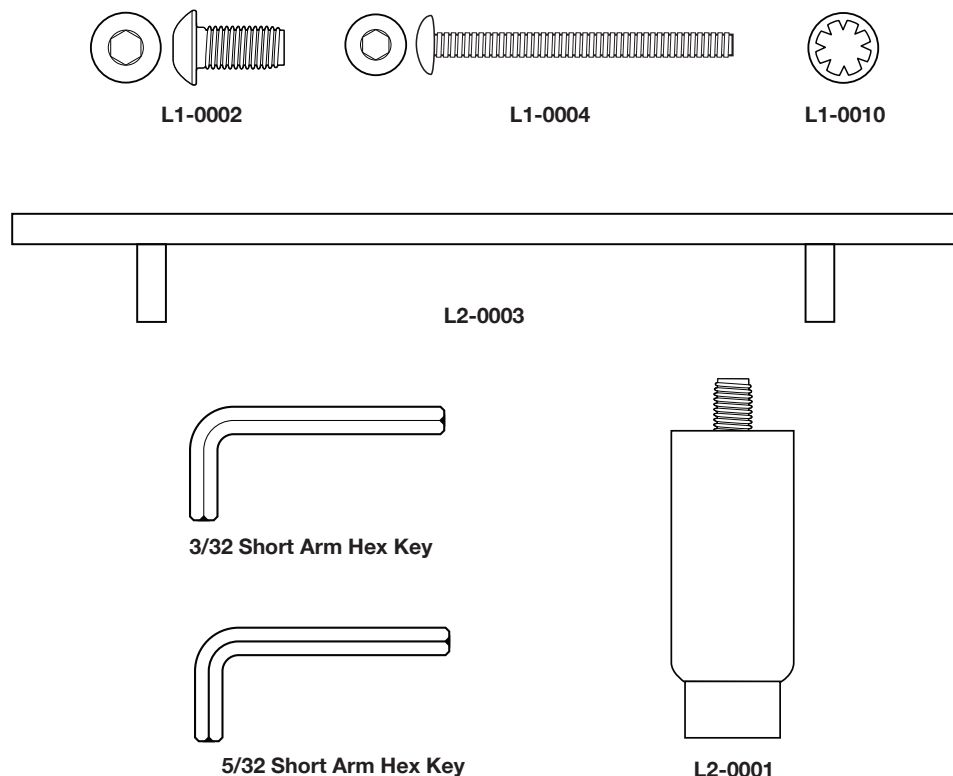

Pre-Assembly - continued

Parts Included for 24 inch Trash Cabinet

NOTE: Parts not shown to actual size. Please check to make sure all parts are accounted for before assembling. Each part is labeled with the part number. It is recommended NOT to remove part number until after it is assembled.

Number	Part #	Description	Quantity
1	BMT2426ASSY	Bottom Assembly	1
2	SP3626V3	Side Panel	2
3	CP3626V3	Back Corner Post	2
4	CPFL3626V3	Front Corner Post, left	1
5	CPFR3626V3	Front Corner Post, right	1
6	BP2426	Back Panel	1
7	TPT2426	Top Panel, Front	1
8	TPB2426	Top Panel, Back	1

Number	Part #	Description	Quantity
9	TDASL1016	Left Angle Support	1
10	TDASR1016	Right Angle Support	1
11	TDDP1831ASSY	Trash Door Assembly	1
12	TDR2426ASSY	Trash Drawer Assembly	1
13	TDSS2204	Slider Support	1
	CC125375	Bracket	1 for each filler panel

Alternative Parts for 24 inch Trash Cabinet

Number	Part #	Description
2A	SPF3626V3	Side Panel Filler
2B	SPNLBSASSY	Brown Stone Side Panel
2C	SPNLGSASSY	Gray Stone Side Panel
6A	BPF2426	Back Panel Filler
6B	BPNL24BSASSY	Brown Stone Back Panel
6C	BPNL24GSASSY	Gray Stone Back Panel

Pre-Assembly - continued

Parts Included for 24 inch Trash Cabinet

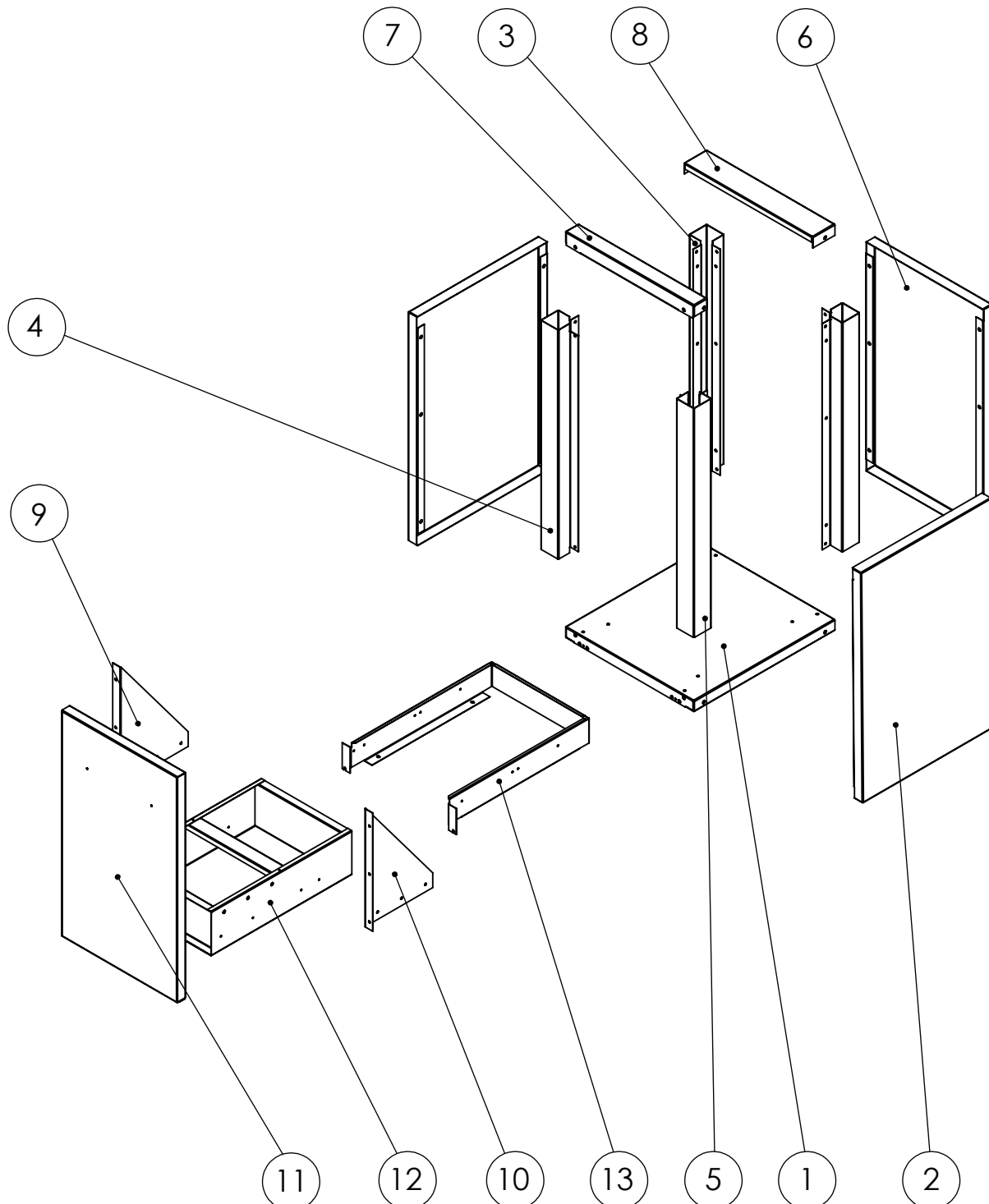

Assembly

1 Attach the front corner posts to the bottom assembly.

Parts needed for 24 inch Trash Cabinet

1	Bottom Assembly	BM2426ASSY
1	Front corner post, right	CPFR3626V3
1	Front corner post, left	CPFL3626V3
2	Lock washers	L1-0010
4	ButtonSoc Cap screws	L1-0002
	Short Arm Hex key	

Lay the bottom assembly on a flat surface. Start with the front right corner post, positioning the notched part of the post up. **(see fig. 1)** Attach the front corner post to the bottom assembly using 2 ButtonSoc Cap screws and 1 lock washer, (commonly known as a star washer) with the Short Arm Hex key. First, insert the front screw with a lock washer. * **(see fig. 2)** Then insert the side screw with no lock washer. Do not tighten all the way. Repeat for the left front corner post.

***NOTE:** Lock washer goes only on the front of the post and bottom assembly. Use only a screw for the side of the post and bottom assembly.

Figure 1

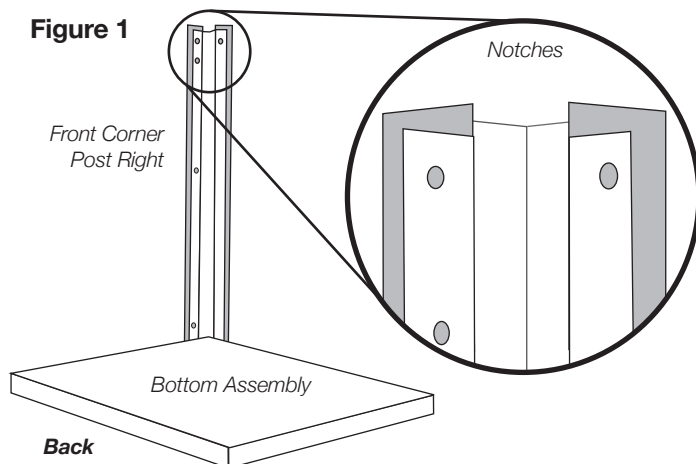
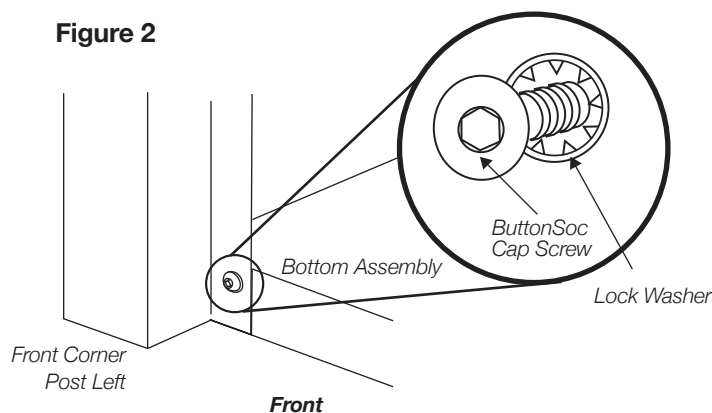

Figure 2



2 Attach the back corner posts to the bottom assembly.

Parts needed for 24 inch Trash Cabinet

2	Back corner posts	CP3626V3
4	ButtonSoc Cap screws	L1-0002
	Short Arm Hex key	

Attach a back corner post, notches at the top, with 2 ButtonSoc Cap screws and Short Arm Hex key to the bottom assembly. **(see fig. 3)** Do not tighten all the way. Then attach the other back corner post with 2 ButtonSoc Cap screws and Short Arm Hex key. Do not tighten all the way.

Figure 3

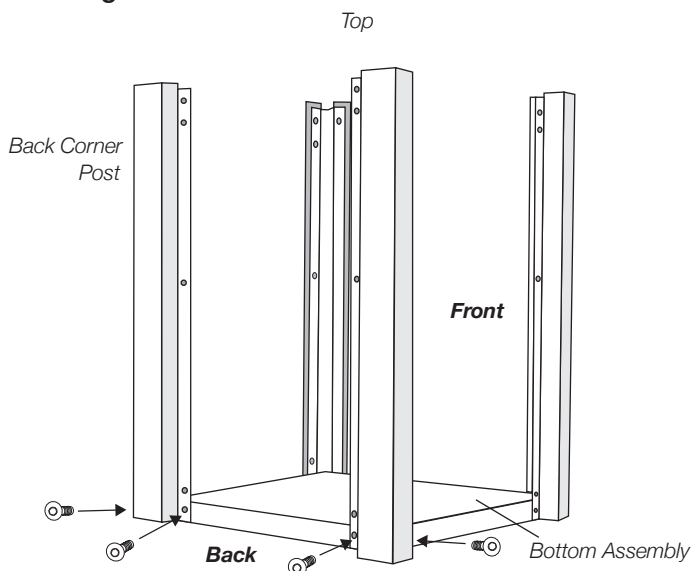

Assembly - continued

3

Attach the front top panel.

Parts needed for 24 inch Trash Cabinet

- | | | |
|---|----------------------|---------|
| 1 | Top Panel, Front | TPF2426 |
| 2 | Lock Washers | L1-0010 |
| 4 | ButtonSoc Cap screws | L1-0002 |
| | Short Arm Hex Key | |

Attach front top panel to both front corner posts (**see fig. 4**) by placing 2 ButtonSoc Cap screws in the front of each post with 2 lock washers and 2 ButtonSoc Cap screws in the side with NO lock washers. (**see fig. 5**) Do not tighten all the way.

Figure 4

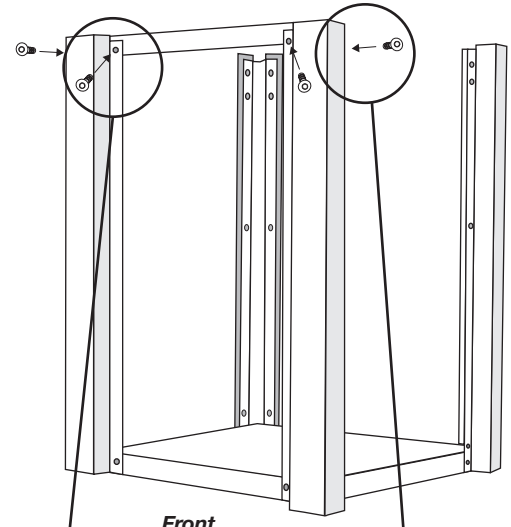
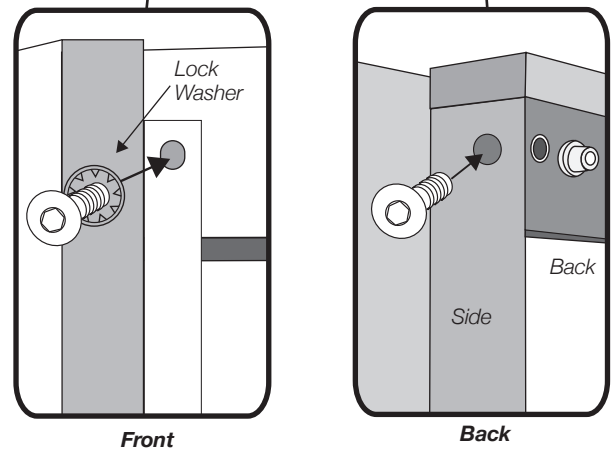

Figure 5



4

Attach the back top panel.

Parts needed for 24 inch Trash Cabinet

- | | | |
|---|----------------------|---------|
| 1 | Top Panel, Back | TPB2426 |
| 4 | ButtonSoc Cap screws | L1-0002 |
| | Short Arm Hex Key | |

Attach back top panel to both back corner posts by placing 2 ButtonSoc Cap screws in the front of each post and 2 ButtonSoc Cap screws in the side. Do not tighten all the way. (**see fig. 6**)

Figure 6

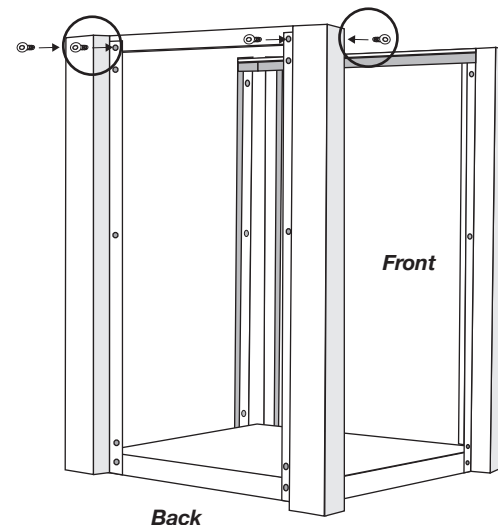

Assembly - continued

Figure 7

5 Square all the posts and tighten screws.

Parts needed for 24 inch Trash Cabinet

- 1 Metal Square
- Short Arm Hex Key

Take a metal square and square up all the posts. As you square up the posts, tighten all the screws. (see fig. 7)

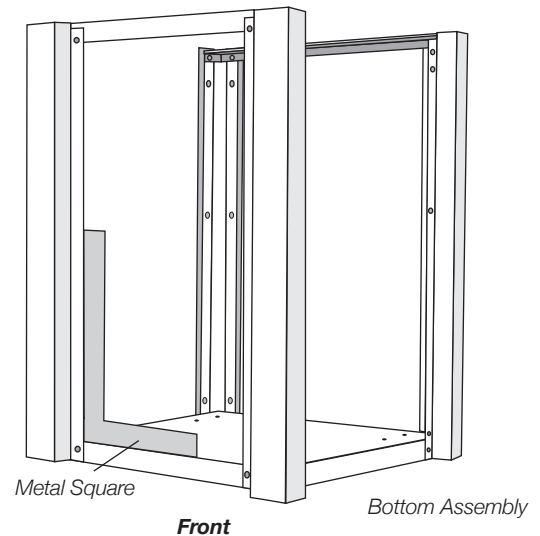

6 Attach the back panel.

Parts needed for 24 inch Trash Cabinet

- 2 Back panels BP2426 *
- 6 ButtonSoc Cap screws L1-0002
- Short Arm Hex Key

To attach the back panel, place the panel between corner posts. Place all the ButtonSoc Cap screws in by hand on the inside of the panel and post. (see fig. 8) **NOTE:** The panel will only go on one way as the holes match up with the post and panel.

The panel will use 6 screws. Once all the screws are in place, go back and tighten them all with the Short Arm Hex key.

Figure 8

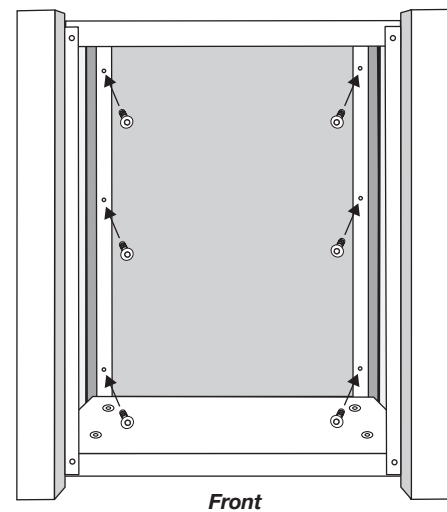

** Part numbers are for stainless steel panels. If you have faux stone or filler panels, you can find part numbers on page 6.*

Assembly - continued

7

Attach the side panels.

Parts needed for 24 inch Trash Cabinet

- | | | |
|----|----------------------|------------|
| 2 | Side panels | SP3626V3 * |
| 12 | ButtonSoc Cap screws | L1-0002 |
| | Short Arm Hex Key | |

To attach side panels, place one of the side panels on one side and screw in all 6 ButtonSoc Cap screws in by hand on the inside of the panel and post. **(see fig. 9)** **NOTE:** The panels will only go on one way as the holes match up with the post and panel. **

Once all the screws are in place, go back and tighten them all with the Short Arm Hex key. Repeat for the other side panel.

NOTE: If using a filler panel for connecting to another unit, see Appendix A at the end of these instructions.

Figure 9

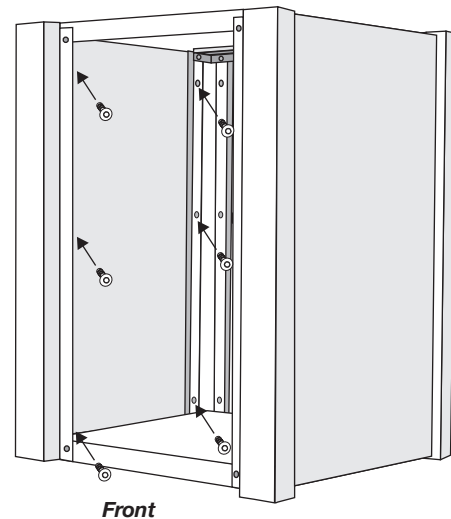

* Part numbers are for stainless steel panels. If you have faux stone or filler panels, you can find part numbers on page 6.

** If you have a left unit – the finished panel goes to the left. If you have a right unit, the finished panel goes on the right. If you have a center unit, filler panels go on both the right and the left.

8

Attach the adjustable legs to the bottom panel.

Parts needed for 24 inch Trash Cabinet

- | | | |
|---|-----------------|---------|
| 4 | Adjustable legs | L2-0001 |
|---|-----------------|---------|

Lean cabinet on its side, if necessary, being careful not to scratch the surface. Screw in 1 of the 4 legs to the bottom panel into the hole by turning it clockwise. **(see fig. 10)**

Repeat for the other 3. Adjust the bottom part of the leg by turning counter clockwise until the unit is level. **(see fig. 11)**

NOTE: It is advised to start at the highest point of where the legs touch the surface for leveling.

Figure 10

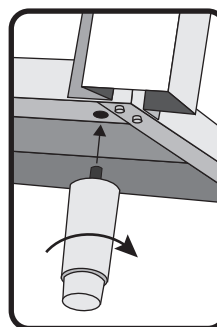
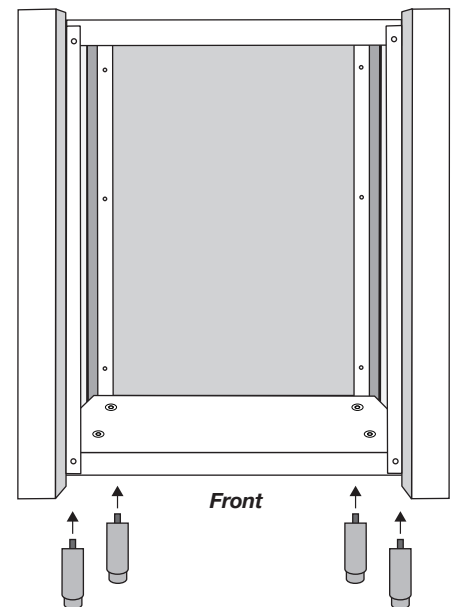
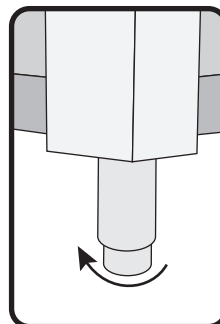

Figure 11



Assembly - continued

Figure 12

9

Attach the angle supports to the door.

Parts needed for 24 inch Trash Cabinet

1	Trash Door Assembly	TDDP1831ASSY
1	Left Angle Support	TDASL1016
1	Right Angle Support	TDASR1016
6	ButtonSoc Cap screws	L1-0002
	Short Arm Hex Key	

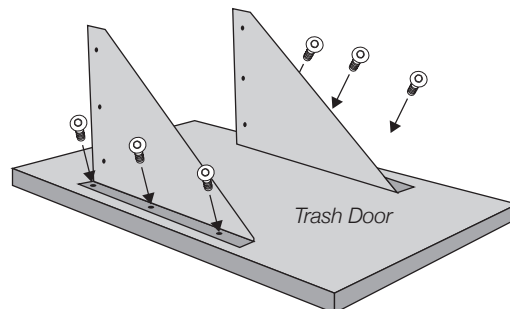

Lay the door face down on a flat, clean surface so it does not get scratched. Attach the left angle support to the door with 3 screws. (Do not tighten all the way.) Then repeat for the right angle support. (see fig. 12)

10

Attach the slider support.

Parts needed for 24 inch Trash Cabinet

1	Slider Support	TDSS2204
	Short Arm Hex Key	

Detach the slider support from drawer. Remove the 4 screws that are in the bottom assembly and place drawer slide support on bottom assembly (so the slide pulls outward) and replace the 4 screws. (see fig.13) The front 2 screws on the post should be tightened around the front flange on the slider support. (see fig.14)

Figure 13

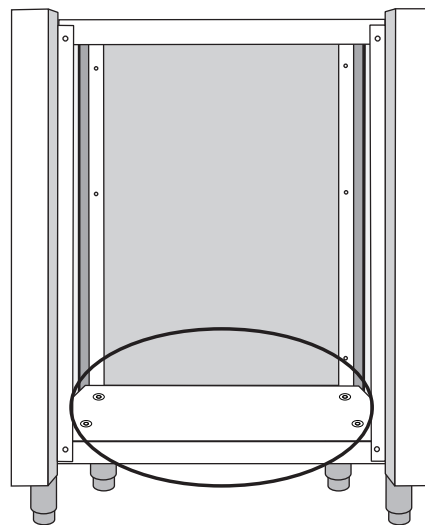
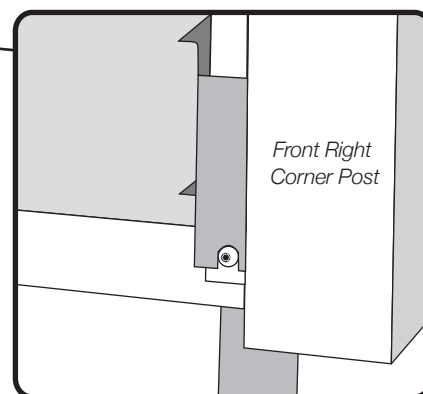
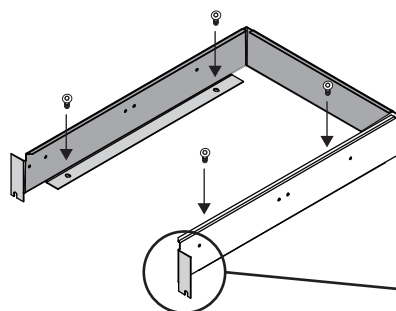

Figure 14



Assembly - continued

Figure 14

11

Attach the trash drawer to the side angle supports.

Parts needed for 24 inch Trash Cabinet

- | | | |
|---|-----------------------|-------------|
| 1 | Trash Drawer Assembly | TDR2426ASSY |
| 6 | ButtonSoc Cap screws | L1-0002 |
| | Short Arm Hex Key | |

Place the drawer between the side angle supports on the door, making sure to match up the holes (3 for each side) and insert ButtonSoc cap screws. Tighten all screws. (see fig. 14)

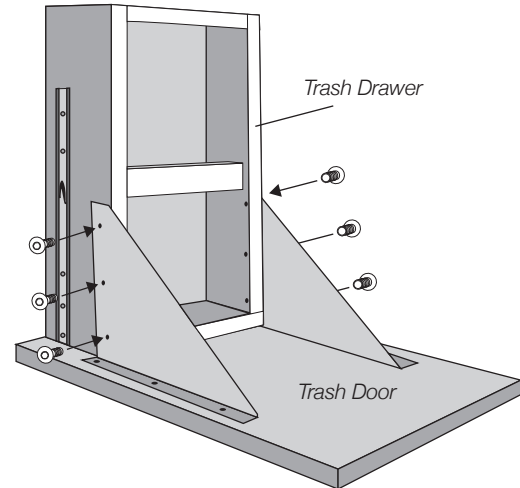

12

Slide drawer onto the slider support and attach door handle.

Figure 15

Parts needed for 24 inch Trash Cabinet

- | | | |
|---|--------------------------|---------|
| 1 | Door Handle | L2-0003 |
| 2 | 1¾" ButtonSoc Cap Screws | L1-0004 |
| | Short Arm Hex Key | |

Pull out slides that are in the cabinet. Slide door with attached drawer back onto the slides. (see fig. 15)

Attach the handle to the door using 2 8-32 x 1¾" ButtonSoc Cap screws.

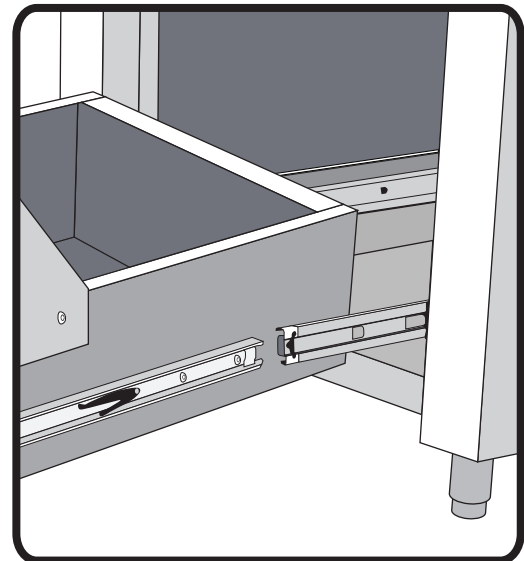

Appendix A

Attaching one cabinet to another.

Parts needed for 24 inch Trash Cabinet

2 Clips per cabinet CC125375

To attach one cabinet to another, butt cabinets up to each other. Level the two cabinets. Remove the top two screws. **(Fig. 16)** Take bracket and place down inside the corner posts and line up with screw holes. Using screws that were removed, reinsert them into the bracket and then the cabinet. **(Fig. 17)** Repeat for opposite side. **(Fig. 18)**

Figure 16

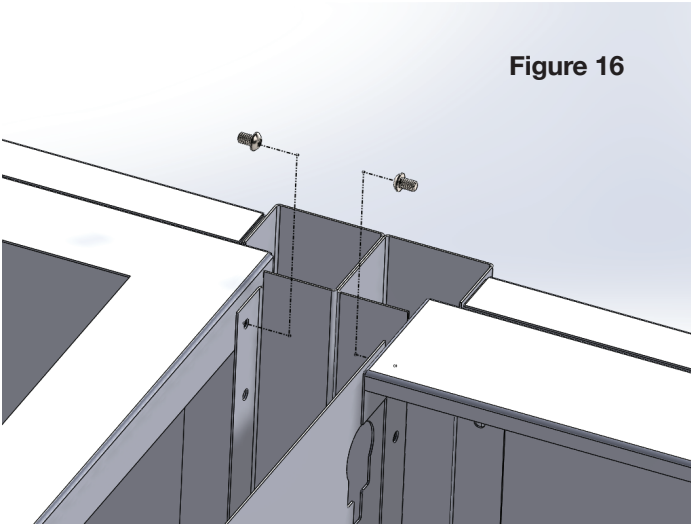

Figure 17

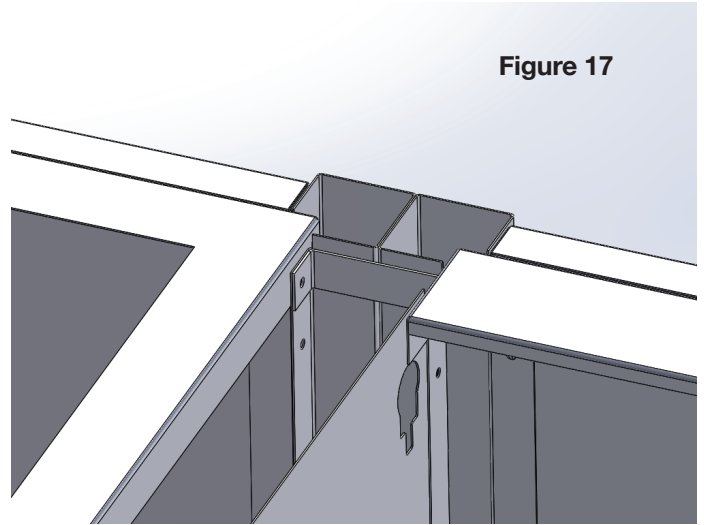
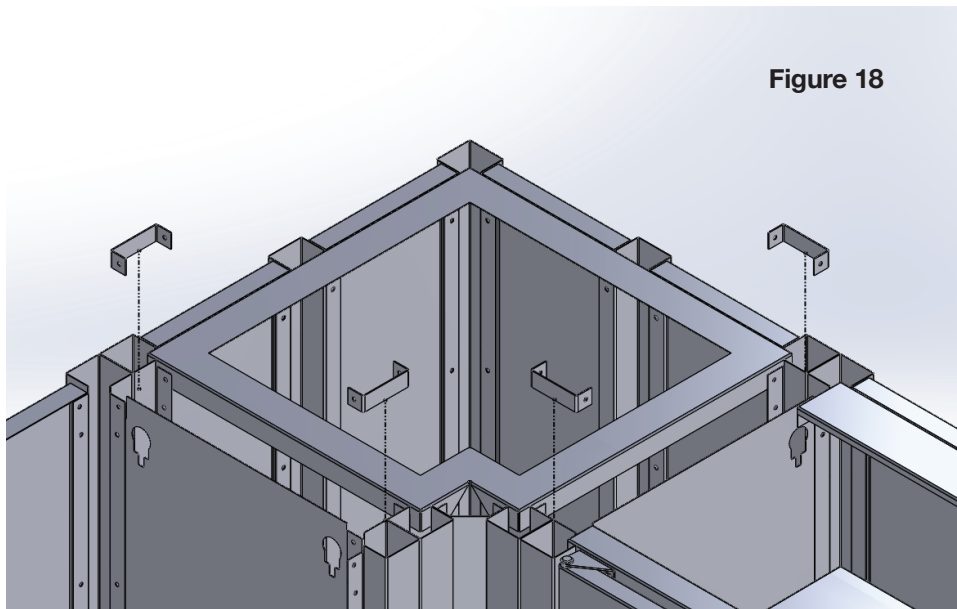

Figure 18



***Thank You.** We appreciate the trust and confidence you have in our products. It is our mission to provide quality products for your backyard. Visit us online to see our full line of Sierra products as well as other products Cardinal Systems Inc. has to offer for your backyard entertainment. Thank you for choosing Cardinal Systems.*

Please retain this manual for future use

